

# EQVI100 VIZU SUPER FRIES

## EXPLODED VIEW

- 19-02 BASE
- 19-03 HOOD
- 19-04 HOOD INSERT
- 19-05 HOOD LIGHT HOLDER
- 19-06 REFLECTOR
- 19-08 DRAIN PLATE
- 19-09 BASE SIDE COVER
- 19-10 TOP AND BOTTOM GLASS CHANNELS
- 19-11 LIGHT REFLECTOR
- 19-12 LIGHT HOLDER
- 19-13 TOP LIGHT CLAMP
- 19-15 HOOD SUPPORT
- 19-16 LEFT FRAME UPRIGHT
- 19-18 BOTTOM LIGHT CLAMP
- 19-19 RIGHT FRAME UPRIGHT

- |              |                                 |
|--------------|---------------------------------|
| GSGAST42004  | 2/1 GASTRONOME PAN (100mm DEEP) |
| VISW17       | RED ROCKER SWITCH               |
| VILE14       | SWITCH MEMBRANE                 |
| MF R1H34AFM  | ADJUSTABLE FEET                 |
| MF BS61096   | GUIDE PINS                      |
| MF PT40042   | PLASTIC BUNG                    |
| V1566X401    | GLASS                           |
| GS GAST40042 | PAN                             |
| MF 16202     | GROMMETS                        |
| MF 605-649   | GROMMETS                        |
| BAHH210500W  | 500W LAMP                       |
| MF PLATE     | SERIAL PLATE                    |

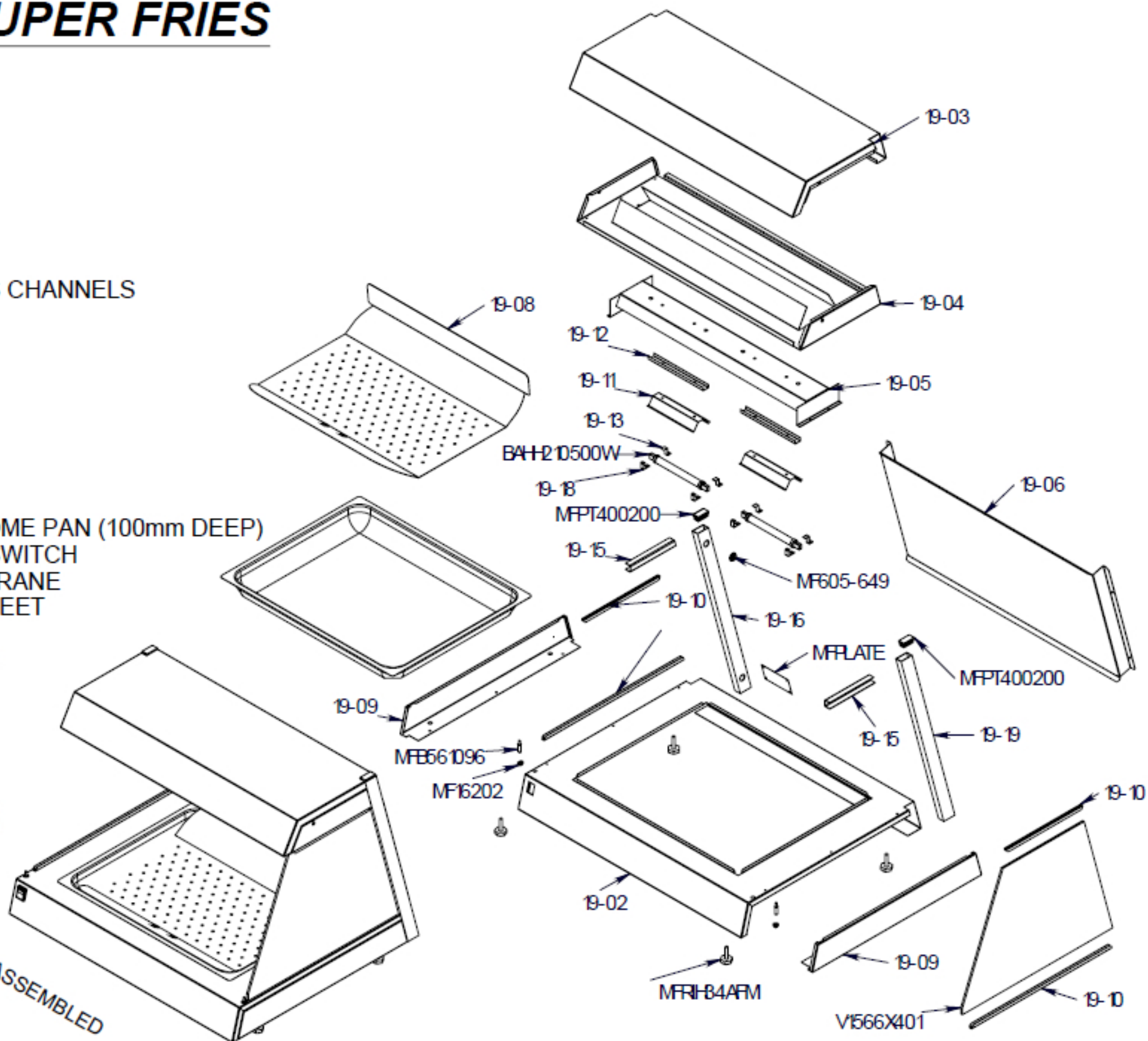

**DRAWN BY: BECKY GRIGGS**  
**DATE: 23/09/04**  
**ISSUE: 01**